

# FOR LEASE

# 21,499 SF



## 137 Vander Street ~ Corona, CA

- ❖ Approx. 1,800 SF of Brand New Office Space
- ❖ Immediate Access to 91 Freeway
- ❖ New Roof
- ❖ 1.09 Acre Parcel
- ❖ 600 Amps, 120/208 Volt, 3 Phase, 4 Wire Power (*verify*)
- ❖ Corner Lot with Excellent Curb Appeal
- ❖ Secured Yard Area
- ❖ 18' Warehouse Clearance
- ❖ Drive Around Building
- ❖ 3 Extra Large Ground Level Doors (two 14' x 18' & one 14' x 20')
- ❖ Sprinklered

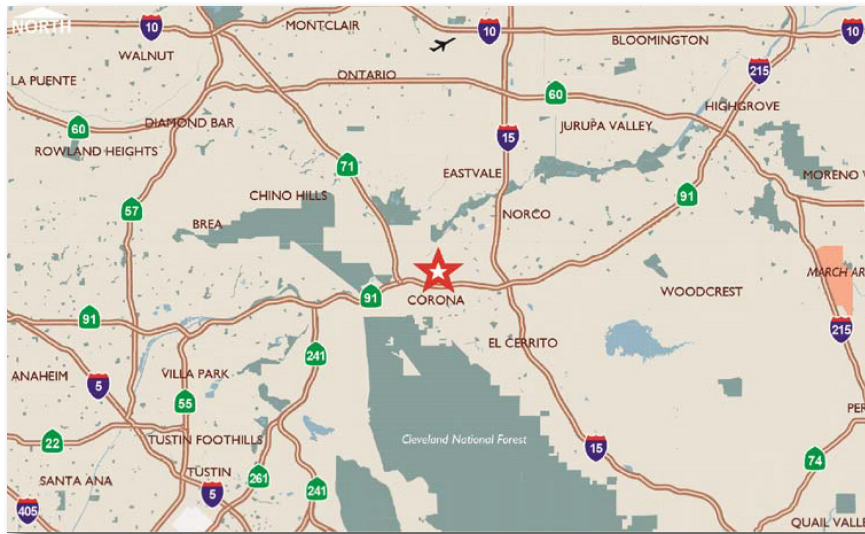

For Further Information, Contact:



Patrick Delaney  
714.564. 7 1 2 7  
pdelaney@lee-associates.com  
BRE #00962861

Dave Hunsaker  
714.564. 7113  
dhunsaker@lee-associates.com  
BRE #00845288

Lee & Associates Commercial Real Estate Services, Inc.—Orange | Corporate ID 01011260 | [www.leeassociatesorange.com](http://www.leeassociatesorange.com)  
1004 W. Taft Avenue, Suite 150 | Orange, CA 92865 | 714.647.9100 | F: 714.543.5285

©2014 Lee & Associates® All information contained herein has been provided by Lessor and/or third parties, but has not been independently verified by Lee & Associates or its agent(s). Lessee and interested parties should independently verify all information communicated by these sources.

# FOR LEASE

## 21,499 SF



### 137 Vander Street ~ Corona, CA

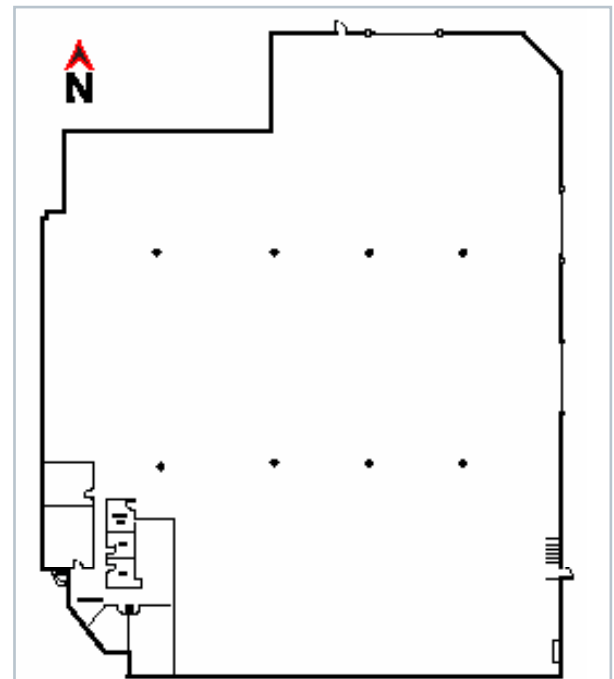
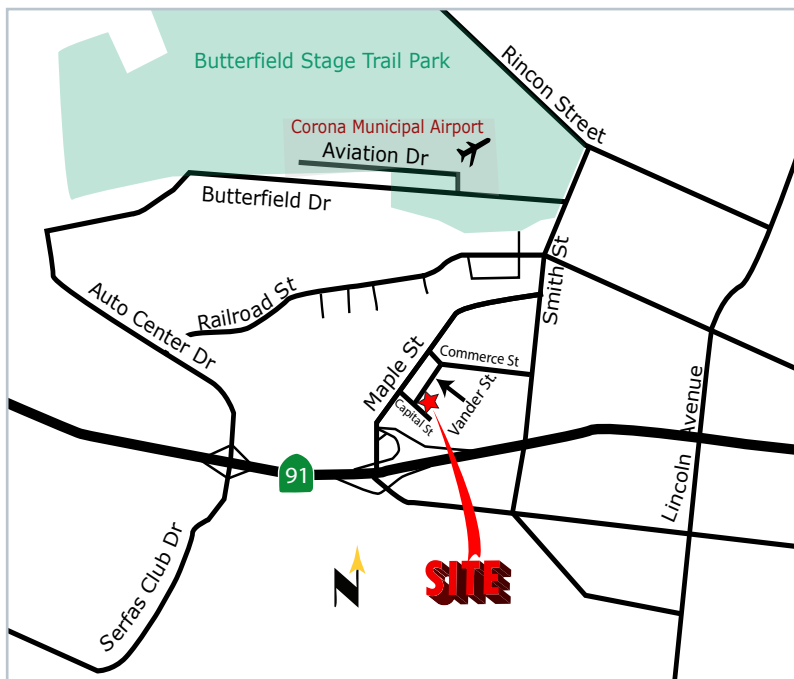

For Further Information, Contact:



Patrick Delaney  
714.564. 7 1 2 7  
pdelaney@lee-associates.com  
BRE #0096286B

Dave Hunsaker  
714.564. 7113  
dhunsaker@lee-associates.com  
DRE #00845288

Lee & Associates Commercial Real Estate Services, Inc.—Orange | Corporate ID 01011260 | [www.leeassociatesorange.com](http://www.leeassociatesorange.com)  
1004 W. Taft Avenue, Suite 150 | Orange, CA 92865 | 714.647.9100 | F: 714.543.5285

©2014 Lee & Associates® All information contained herein has been provided by Lessor and/or third parties, but has not been independently verified by Lee & Associates or its agent(s). Lessee and interested parties should independently verify all information communicated by these sources.